

Welcome to our Newsletter

The past six months have seen a continuation of a very busy cycle of work. Ongoing work with major clients such as Tesco, The United Church Schools, United Learning Trust with their Academy schools has encouraged us to open another office to better serve our clients in the Midlands and the North of England. We are delighted to have opened our Liverpool office and to be a part of the exciting regeneration of that great city.

Building Magazine recently published its Top 200 Construction Consultants (all disciplines) list. CMPB have jumped up the table from 178th in 2002/3 to 139th in 2003/4. Whilst size certainly is not everything it is important that we have plenty of the right quality and calibre of technical and qualified staff to deliver a high standard of service to our clients. We are proud of our staff and the committed service they give. The amount of repeat work we receive from a significant majority of our clients is testimony to this quality service.

2005 is our 50th Anniversary Year and we are planning a number of events to celebrate the anniversary (details to follow). It promises to be another busy year with plenty of varied and interesting work.

We hope you enjoy reading about some of our 2004 projects and that you have a Happy and Peaceful Christmas and a Prosperous New Year!



CMPB Receive Royal Recognition for Our Work at Lambeth Academy

On 26th October, 2004, Lambeth Academy was formally opened by Her Majesty The Queen. CMPB were the Construction Project Managers and Quantity Surveyors for this wonderful new school.

In over an hour long visit, Her Majesty was welcomed to the Academy, which only opened at the beginning of September, by its 184 Foundation Students.



Her Majesty The Queen Formally Opens The United Learning Trust's New City Academy School and is introduced to Graham Harvey-Browne Managing Partner, CMPB

Staff and over 300 guests including DfES Ministers, David Miliband MP and Stephen Twigg MP and representatives of the Academy's sponsor, the United Learning Trust, watched The Queen sign the Academy's Visitors Book before she unveiled a plaque to commemorate her visit.



In a formal ceremony, Her Majesty was greeted by 8 Academy students who gave welcomes in languages typically spoken in their homes and was entertained with music and a series of poems written by Academy students especially for the day.

The Queen was additionally presented with a special commemorative plate and cups to mark the occasion.

Before leaving the Academy, the Bishop of Southwark conducted a Blessing and the Queen was presented with a posy of flowers to thank her for visiting the Academy.

After the Queen's visit, Sir Ewan Harper, Chief Executive, United Learning Trust said: "We are incredibly proud that The Queen chose to come here to Lambeth Academy; the first Academy that she has opened. It is an immense honour for us and we had a wonderful day. Everyone at the Academy has worked so hard to make the visit a success and the behaviour of the students was impeccable. We were particularly keen to ensure that The Queen saw the cutting-edge technology with which, as a brand new school, our Academy is very well-equipped. I

very much hope that The Queen was impressed with what she saw".

The Academy is sponsored by the United Learning Trust (ULT). ULT is a not-for-profit educational charity and one of the largest sponsors of Academies in the UK.

In total it is expected that ULT will open ten Academies over the next five years.

Lambeth Academy is housed in a brand new £25million building which has been designed by the Howarth Litchfield Partnership, an award winning firm of architects. It is equipped with state-of-the-art facilities, including a Learning Resource Centre, a professional level recording studio and an interactive whiteboard in every classroom.

Liverpool : New Office and Exciting Developments

CM Parker Browne are pleased to announce the launch of a new office in Liverpool. Our new office is set right in the heart of Liverpool, close to The Liver Building - in the impressive India Building - a famous landmark of the city with a lavish entrance mall named after the Holt family who built the block as headquarters for their shipping line in the nineteenth century.

Our Liverpool Office will enable us to better serve our clients and their projects in the north of England - including the forthcoming United Learning Trust Academy School at Manchester Salfords, ongoing projects for Tesco, for United Church Schools in Hull and for Bolton School.

Our Liverpool team is headed up by Stan Inskip an experienced Construction Project Manager who joins us from Japanese Contractor, Kajima, where he was Operations Director for the north-east of England. Stan joins us as an Associate. The team includes Shirley Hynes (Senior Project Manager), Graham Howell (Senior Surveyor) and Claire Laroc (Secretary).

Robert Ebdon and Rob Buckley are the Partners responsible for Liverpool.

We are marking the opening of our Liverpool pad with a celebration party on 17th December, 2004 at 'The Cavern' - a re-creation of the Beatles' famous performing venue set in the City's Albert Docks. A live tribute Beatles band will be playing to our guests; it promises to be a memorable evening!



The Entrance Mall to The India Buildings, where our new Liverpool Office is situated.

Staff News

In the past six months, we have welcomed the following new staff:

- Oluchi Uduku - Senior Project Manager based in London
- Dawn Twitchett - Planning Supervisor based in London
- Stan Inskip - Associate, Project Manager i/c Liverpool office
- Roy Blamey - Head of Planning Supervision / Health & Safety
- Clive Sapsed - Senior Project Manager based in Guildford office
- Peter O Neil - Building Surveyor based in Guildford

Congratulations to Oluchi Uduku on having gained her Prince 2 Practitioner Certification. Congratulations also to Robert Ebdon on having been elected a Fellow of The Royal Society (FRSA) and to Paul Grinham for having been invited to become a Member of ASCHB (Association for Studies in the Conservation of Historic Buildings).

Our Quantity Surveyors Appointed To Make the Figures Crystal Clear at The Palace!

CM Parker Browne are very excited to announce that they have been selected as Quantity Surveyors to the design team currently developing a scheme for the development of a 'new' Crystal Palace on the site of the famous 1854 building in Crystal Palace Park, Sydenham, London. The scheme is one of several competing for the re-development of this important historic site.

The vision is for the new Palace to be a worldwide home for sports and could include an artificial snow ski slope, an indoor Olympic sized swimming pool, ice skating, wall climbing and all world sports in actuality or in simulation. In addition to this, sports medicine, clothing, equipment, hygiene, health, dietary matters, management, promotions, media, history and culture will all be represented there.

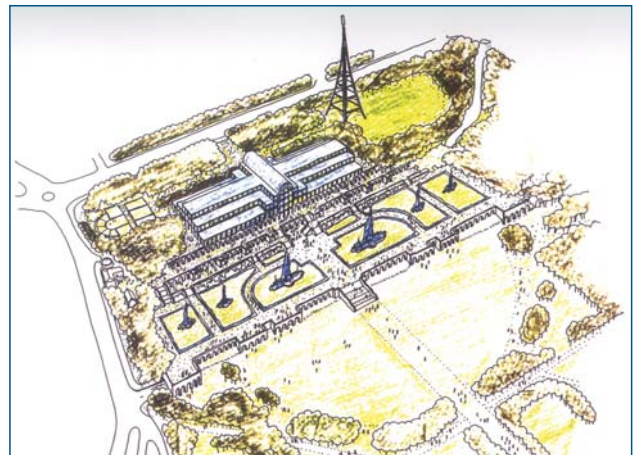

Architect's Impression of the proposed re-development of The Crystal Palace : World of Sport

The 'Crystal Palace: World of Sport' proposal is timely in the context of London's bid for the 2012 Olympic Games and indeed could become a component of that bid. However as it is able to come into being without public funding its uses extend well beyond this project.

Infrastructure will play a vital part in the ultimate success of this scheme and will include transportation, car parking, pedestrian access and soft and hard landscaping. Each of these elements must be conceived ecologically and socially and must also feature as part of the business plan - focussed locally and strategically.

CMPB Score an 'Excellent' Bill of Health on A Harley Street BREEAM Assessment



Under the leadership of our Project Managers, the hard work of the Design Team to incorporate environmental design solutions to a Grade II Listed Georgian building has paid off. The Building Research Establishment recently awarded the Project an "Excellent" Certification under its Environmental Assessment Scheme.

BREEAM (Building Research Establishment Environmental Assessment Method) is now becoming widely recognised as the most thorough and holistic tool in assessing and ultimately in developing the design of a project with regard to the long term environmental efficiency of buildings. A building's design and specification is marked against pre-determined criteria covering management, health and well being, energy, transport, water, materials, land use, ecology and pollution.



Our Client, The Crown Estate has, as have many other Corporate Bodies with large building portfolios, revised their building policy to incorporate BREEAM assessments on all their buildings under construction or refurbishment.

Harley Street was considered a test case for our Client due to it being one of the first Listed buildings that The Crown Estate has had assessed in this way.

High standards have indeed now been set!

The achievement at Harley Street has highlighted that a Listed building can be sensitively refurbished and repaired for modern day use without it being detrimental to the building's historic fabric, the environment or indeed a client's budget!

The CMPB Golf Day, 2004



Following the success of several years at Tyrrells Wood the CMPB golf day was this year moved to a new location – to one of our clients – at Effingham Golf Club in Surrey (who by pure coincidence, have just appointed our Building Surveyors for their new Ladies Locker Room contract). All our guests who attended enjoyed a superb day at Effingham

After weeks of continuous rain the weather broke for a single day and the brollies came out purely to keep the sunshine at bay.



Les Deane and his team on their way to success in this year's golf day.

As a change from an individual competition our Partner, Simon Worthy, organised a team event to encourage interaction amongst the assembled party. After a little deliberation at the beginning everyone set out with the complex scoring system all understood.

The event was slightly marred by an unfortunate accident to Stuart Hawkes of Vail Williams who twisted his ankle when leaving a golf buggy only to land on the grass with a dented pride and a dislocated shoulder – we wish him a speedy recovery. Who knows what could have happened - for his team finished 3rd without Stuart hitting a ball in anger!

The event was won by Keith Hassett from EDF Energy, Bob Hackman from the Thomason Group, Steven Morrice from McKay Securities Group and Les Deane (our recently retired Partner who used to organise our Golf Days - so no fix there!).

The individual prizes were won by Steven Morrice from McKay Securities Group and Graham Sibley of White Young Green for longest drive and nearest the pin respectively.

Caterham School Get Planning Permission



We are delighted that one of our long-standing clients, Caterham School, has recently received planning permission from Tandridge Borough Council to build its new £4 million Science Building, Kitchens and Dining Hall project. The design team have been working on the scheme for the past nine months and documents will be issued to main contractors for tender in February, 2005. It is expected that construction work will commence in May 2005 and that the completed building will be opened ready for the start of the academic year in September, 2006.

The new facilities have been designed by Miller Bourne Architects with Thomasons acting as Structural Engineer and Emanuel Smith Partnership as Services Consultant. CMPB are acting as Project Manager, Quantity Surveyor and Planning Supervisor.

A High Degree of Service at The University



The refurbishment of a new multi-disciplinary teaching laboratory for the School of Biomedical and Molecular Sciences was completed in time for teaching to commence at the start of the autumn semester. This is the first phase of a two phase project and is the third project undertaken by CM Parker Browne for the School where they have undertaken Quantity Surveying, Project Management, Building Surveying and Planning Supervisor Services. Building works on the £1.8 million project are being undertaken by Modus Interiors. The work consisted of the complete stripping out of the existing laboratories and formation of new areas with new floors and ceilings, specialist laboratory benching and new mechanical and electrical installations which



incorporated 17 new fume cupboards. The second phase is a Centre for Neuro Science and is a specialist research facility; work will complete at Christmas.

New Multi Disciplinary Teaching Laboratory for the School of Biomedical & Molecular Science at the University of Surrey completed for September 2004.

Our Building Surveyors Win Design Award For Fitting A Quart into A Pint Pot

The Governors of St Edmund's Primary School in Godalming, Surrey, approached our Building Surveyors in 2002 with a problem. Their School had been assessed as being too small by the Local Education Authority, with very poor circulation space and under provision of certain facilities.

The Governors were committed to addressing all of these problems but very tight site constraints meant that any development had to be contained within the overall footprint of the existing building. It was also imperative that the alteration/ extension works had to be executed in such a way as to allow the school to continue to function. Further constraints on the design were also imposed by the timetable for Government funding and the available budget.

Achieving planning approval was not straightforward but working with the Governors to address the concerns of the local residents we gained approval for what is to be a two phase project.

We are very pleased to say that Phase One was completed this year, with the contract period straddling the summer holiday period and with careful planning all of the objectives have been achieved.

The drawings show the Phase One works; Phase Two is designed and when funding is available further alterations and extensions will be commissioned to link the new block to the main school, enlarge the Hall, re-configure Year 1 and Year 2 classrooms and the staff facilities and to extend the circulation corridors to enable access to all classrooms without entering the central school hall.

As with all successful contracts it has been achieved by a committed and enthusiastic team, working together. Throughout the design and construction process the Governors and Teaching staff of the school, the contractor (local builders, Surrey Construction Ltd) and our surveyors worked together. The project has been a success and all enjoyed the experience.

The Godalming Trust has recognised the complexity of the project and the quality of the result and our Building Surveyors have been presented with a Design Award. The certificate will hang proudly on our office wall.

Declan Runs for Charity



Declan Gleeson (Building Surveyor, Guildford) completed two marathons in October, the Budapest marathon (in 4 hours and 4 minutes) and the Dublin marathon (in 4 hours and 11 minutes). He raised approximately £800 for Cancer Research UK. Congratulations on an outstanding effort!

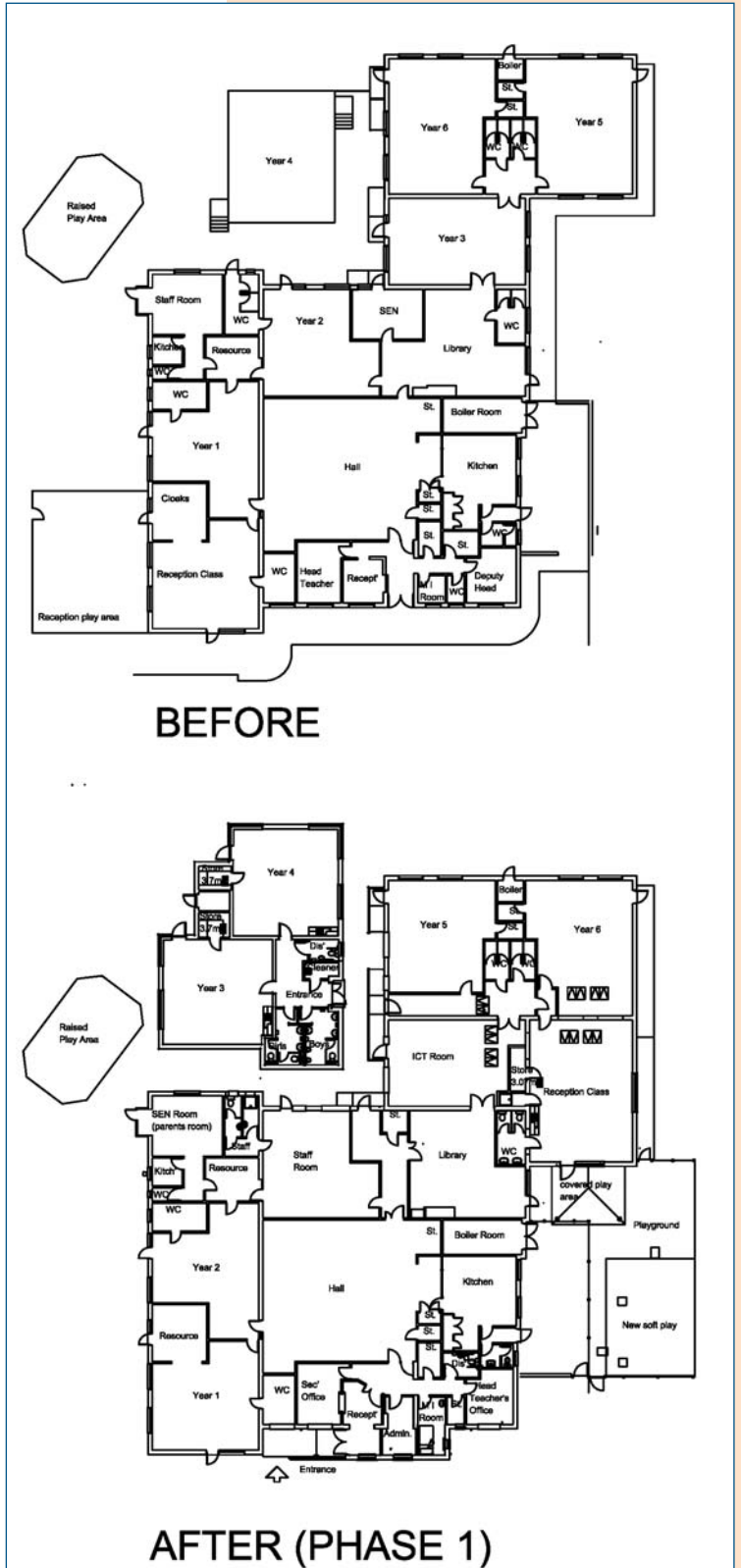

61 Southwark Street
London SE1 0HL
Tel: 020 7928 1066
Fax: 020 7928 1099
southwark@cmpb.co.uk

Milestone House
8 Kings Ride
Camberley
Surrey GU15 4HN
Tel: 01276 682782
Fax: 01276 682008
camberley@cmpb.co.uk

241 High Street
Guildford
Surrey GU1 3BJ
Tel: 01483 510800
Fax: 01483 510808
guildford@cmpb.co.uk

Admirals Offices
The Historic Dockyard
Chatham
Kent ME4 4TZ
Tel: 01634 814714
Fax: 01634 815999
chatham@cmpb.co.uk

Suite 607, 6th Floor
India Building
Water Street
Liverpool L2 0RA
Tel: 0151 227 9151
Fax: 0151 227 9152
liverpool@cmpb.co.uk